

Cultivating Curiosity

Outdoor Learning Project



Planned for Summer 2022 - completing Autumn 2022



Context 1

As a staff group we passionately believe that children's learning should develop curiosity, creativity and enable our nine values to be experienced and exemplified in a range of contexts.

Nature provides a rich backdrop throughout the year, challenges us and enables teachers to develop curriculum learning and wellbeing opportunities.

As a school community we want to provide the best possible experiences for all children, including those that use our site from preschool and the holiday club.

Enduring, equitable relationships through partnership will sustain this project and deliver the best outcomes for our pupils.



Context 2

Climate change, sustainability, soil to plate themes need to be a part of a young person's lifelong learning and we are the catalyst for those early thoughts, plans and decision pathways.

Financial responsibility is an area we want to develop through growing enterprise projects and giving ownership to our children - responsibility and consequence.

In an increasingly technological World the connections with the outside are ever more vital for children.

Space is important and time within a space will support wellbeing and mental health and provide opportunities for conversations and / or personal reflection.



Partnerships - community

The Allotment Association | Gardening Association: volunteer and guidance from the local community - working alongside our pupils and staff to create a resource of knowledge, experience and volunteering on site.

The Parish Council: integration with local plans around the Abington pump track, local events and encouraging community use of the resources.

Preschool | Out of school Club | Holiday Club: maximising the site usage by other users and engaging all members of our community (baby and toddler group > preschool > holiday club).

Parents Teachers and Friends of Great Abington (PTFA): our parent and teacher organisation will use the space for community events.



Partnerships - local area

We see the following strong and reciprocal relationships as crucial to the success of this sustainable programme:

Granta Park: Integration with community initiatives, art installations, community support projects.

Cambridge University (Botanic Gardens): project outreach support, research projects (*to be confirmed* Spring 2022).

The Leys School: artwork, drama workshops, geography and history projects.

Cambridgeshire County Council: as a Tall Trees ambassador school we will be training, advising and inspiring others to develop their outdoor practice.



The ambition for our pupils will ensure that...

- **every child** understands and can talk about sustainability ✓
- **every child** understands and can talk about biodiversity ✓
- **every child** understands and can talk about growing produce ✓
- **every child** understands and can talk about nature and its impact on our well-being ✓



Our Vision

Enquiry based learning is at the heart of our curriculum - we want to inspire and fire up the curiosity in our pupils

Perspective is so important - challenging our norm by adding height (grass hills) that changes outlooks and vistas

Time and space support calm - a feeling of being at one with nature - in these times this is so important for all



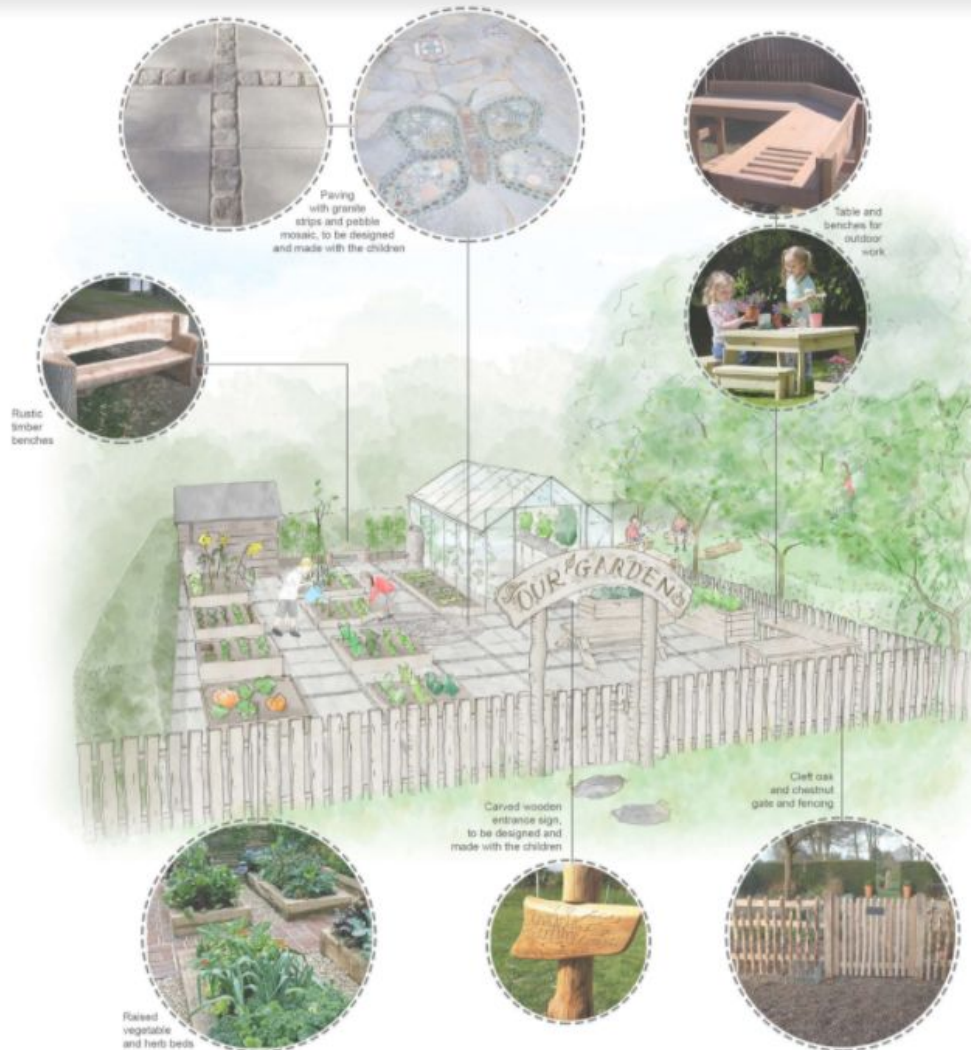

Our Vision

Re-addressing understanding of food production and consumption - enterprise, health and life skills

Hands on activity through ownership - accessible through the day (lessons and lunchtime)

Collaboration with the expertise that exists in our growing community

Collating data for analysis and decision making

Providing a range of roles for pupils that challenges and engages



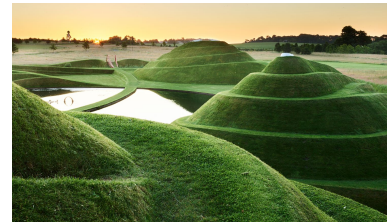
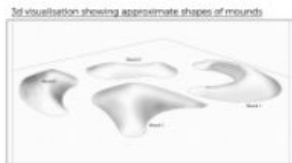
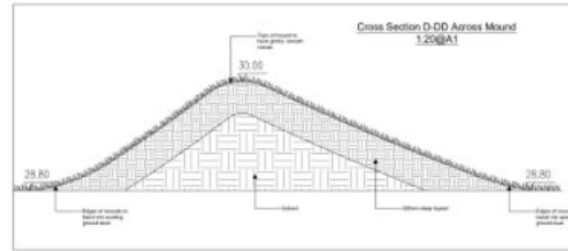
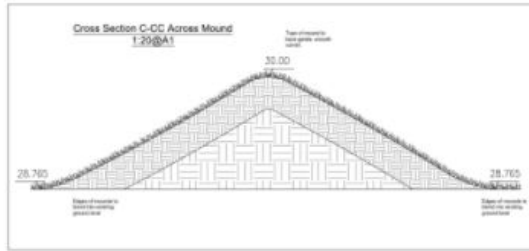
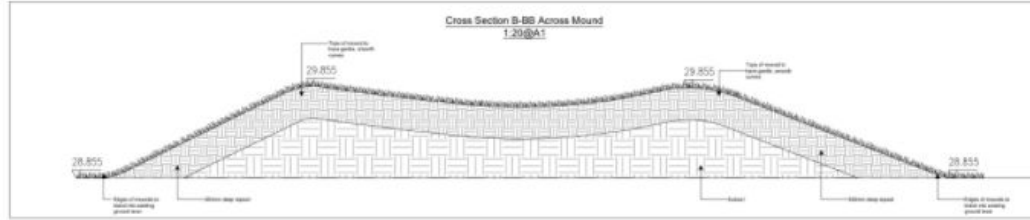
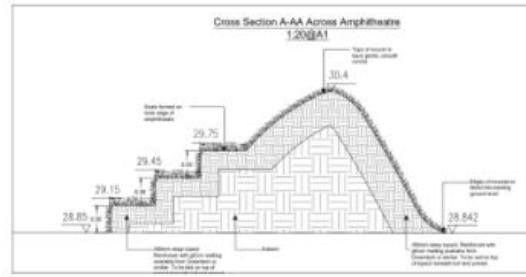

Our Vision

Curiosity, problem solving, creativity needs stimulus - our mounds of marvel could provide such a catalyst

Elevation for vistas and opportunities in the arts, design and space for reflection

Gross motor skills and developing resilience and confidence for our youngest learners on the site

Historical and Geographical perspectives on how form impacts upon settlement and human behaviours



Our Vision

Practical space for a half class group with adult support

Integrated, controllable ventilation for production and consequence enquiry (Technology, Design, Science)

Compost area / benching for scaling up volume of growing (Maths, Science)

Section for higher temperature enabling more specialised crops and flowers - climate, locations relating to our World (Geography / Science)

Hydroponics area - future of growing...

Safe for children - toughened glass

Our Vision

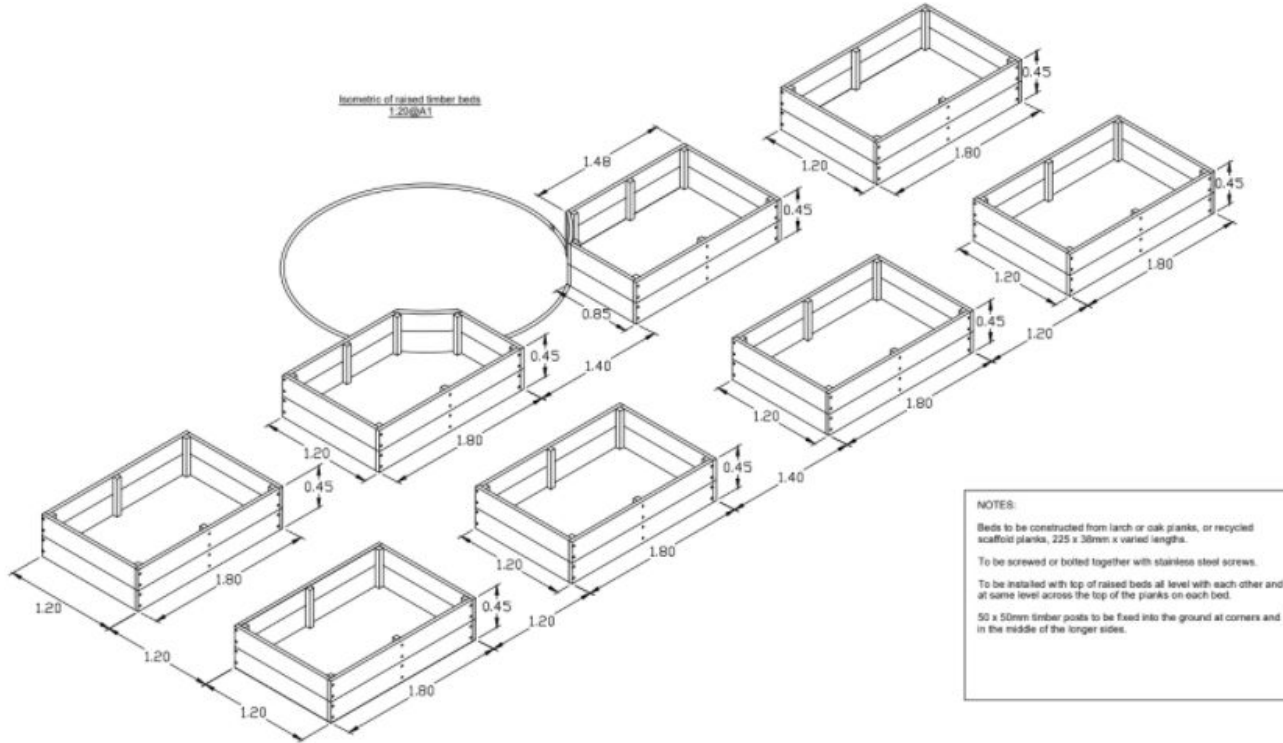

Area ownership by pupils -
developing leadership skills,
responsibility and cooperation

Enterprise skills and a practical
understanding of processes -
grow to sell / financial
understanding / value

Opportunities around
unstructured times and holiday
club provision to support the area

Community projects with local
residents - allotment, parents,
grandparents group

Implementing Our Vision



Honest communication about the challenges and risks associated with the project

Project Manager invested in and knowledgeable about the site

Coordinated labour volunteering programme - identifying and securing specialist assets to support the project

Harnessing community expertise on core aspects of the project: growing, woodcraft, finance, sustainability

Regular reporting to the Full Governing Body - every 8 weeks

Reaching out to all community stakeholders to provide additional funding: business, local councils, associations, parents, friends of the school

Current total: **£38,000** (target £60,000)

For further information

Please get in touch



Headteacher | Guy Underwood

Email: guy.underwood@greatabington.school

Mobile: 07715 413198

Lead Governor | Mark Carter

Email: mark.carter@greatabington.school

Mobile: 07768 687472